

Polytech Products Ltd.

ATTENTION

**ALL WINDOWS AND DOORS MUST BE INSTALLED LEVEL PLUMB, AND SQUARE IN THE OPENING.
IMPROPER INSTALLATION IS THE GREATEST CAUSE OF MALFUNCTION FOR WINDOWS & DOORS**

****NOTE: A straight edge should be used when installing window frame to be sure frame is straight between corners.
Diagonal measurements should be Equal to check Squareness**

INSTALLATION:

1. Check Measurements
2. Remove Screens from operating units.
3. Tilt/Turn Style Windows & Doors: remove sash from frame as this will make unit lighter and easier to install.
 - A. Insert handle into holes drilled in sash. Handle should point to the bottom of window
 - B. Pull gently on the name plate on handle and turn to one side. Two handle screw holes become visible.
 - C. Insert top screw and tighten
 - D. Turn handle 90 degrees and install lower screw.
 - E. Return name plate to original position.
 - F. Tap top hinge pin down about 1". This will allow top of sash to tip in when sash is turned in. With handle in turn position (across the glass) the sash will open in and tip at same time. The sash can be lifted straight up and off the lower hinge, now the frame can be installed.
- 4A. Insert Nail Flange into outer slot in frame. Bottom first, then sides and top last. Nail Flange is cut to proper length and is lettered "T" for top, "B" for bottom and "S" for sides
- 4.B Windows and Garden Doors with 1½ Brickmold and 1" Brickmold have Nail Flange attached and a built in J channel. Nail Flange can be scribed off by installer if not being used when installing. (Not cut off by PolyTech Products Ltd.) J-channel can be scribed out by installer if required. (not cut out by PolyTech Products Ltd.)
- 4.C Windows and Garden Doors can be installed with Galvanized Steel Metallic Installation Clips and the #8 Self Tapping Screws. (self tapping screws for into window frame only and clips provided by PolyTech Products Ltd., Installer provides screws for installing into structure) Not attached by PolyTech. (Do Not screw into Vinyl Frame Profile or Nail Flange Grove)
- 4.D Operating windows & Garden doors can be Pre-Drilled for installation. (Mounting Screws are not provided by PolyTech)
5. Shim window at lower corners and under any vertical posts in frame. Centre frame in rough opening for insulating purposes. Frame should be level and plumb ¾" clearance for rough opening is normally recommended, 3/8" all around (1" rough opening suggested for ICF Construction)

6. Fasten frame to building with screws. If using nails, nails should have a large head (roofing nails) so they will not Pull through the slots in nail flange (not provided by PolyTech) Palm Nailer is recommended
Apply Sealants in accordance the to Building codes requirements for your wall application
Flashing is recommended on all windows and doors

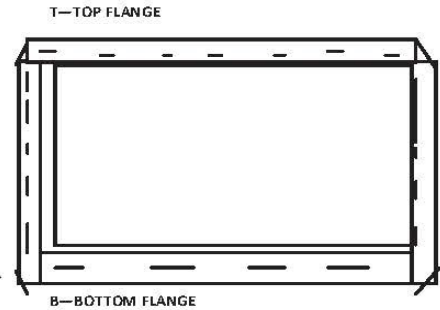
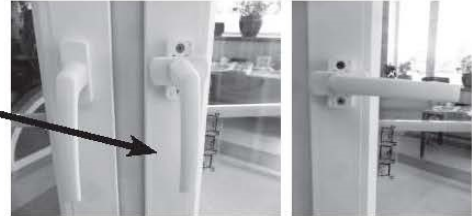

7. Tilt/Turn windows and Doors, Reinstall sash in frame.
8. Check window in each position; (locked, swing, tilt) If adjustments are necessary there is an adjustment screw (4mm Allen Key head) mounted laterally on the top band of hardware on the sash. By turning the screw left or right the sash should position itself for proper operation within the frame. On the bottom left or right hand side of the sash there is a set bolt with a 4mm Allen key head. By turning the bolt left or right you can raise or lower the sash within the frame. The set bolt sits on the tilt & turn hinge mounted on the frame. On the hinge there is also an adjustment to move your sash within the frame left or right by using a 4mm Allen key.
9. After installation is complete and house construction is finished clean all dust off window paying attention to hardware on the sash. Especially the top of the sash where the dust can lay.
10. Lubricate sash hardware annually with a light oil or lithium grease.